

MODELS

MODEL No.	EXT. RANGE (mm)	WEIGHT (kg)
UP-MINI-0-D1	1140 - 1780	11
UP-MIDI-1-D1	1725 - 2950	17
UP-MAXI-2-D1	2105 - 3330	18

SAFE WORKING LOADS

Uni-Prop will deliver up to 750kg of controlled power with **any** model at **any** extension and up to 2000kg at defined extensions.



UNI-PROP COMPONENTS

- | | |
|---------------------|------------------------|
| 01 top plate | 08 outer tube |
| 02 inner tube | 09 ram movement slot |
| 03 threaded sleeve | 10 ram locator boss |
| 04 sleeve slot | 11 ram access chamber |
| 05 top pin assembly | 12 bottom pin assembly |
| 06 collar | 13 base plate |
| 07 collar handle | |

HYDRAULIC ASSEMBLY COMPONENTS

- | | |
|-----------------|--------------------|
| 01 hose spring | 06 hose |
| 02 pump housing | 07 reservoir |
| 03 pump arm | 08 ram |
| 04 ram stick | 09 sealed coupling |
| 05 grip | 10 release valve |

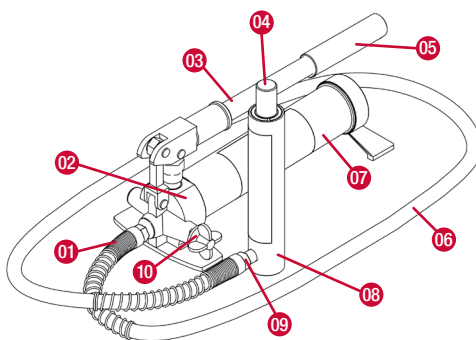

UNI-PROP

- 4mm steel outer and inner tube
- Ø60mm outer tube with Ø48mm inner tube
- 1 piece outer tube incorporating threaded sleeve section
- Defined holes in parallel - inner and outer tubes
- Ram locator boss welded to base of inner tube
- 8mm top and base plates
- Cast collar and galvanised top pin assembly
- Galvanised top and bottom pin assemblies
- Ram movement slot
- Compatible with Strongboy and other standard accessories

HYDRAULIC ASSEMBLY

- Bespoke Uni-Prop ram
- 1.78m 2 S/N hydraulic hose
- Hydraulic pump unit de-rated to 2T
- Maintenance free sealed unit
- High-Density Polyethylene (HDPE) Case

ACCREDITATIONS

Uni-Prop models load tested to BS EN 1065
Hydraulic Assembly CE marked and **de-rated to 2T** for use with the Uni-prop Temporary Support

Comprehensive technical specifications are available on our website.

0800 2545 456

enquiries@uni-prop.com

UNI-PROP.COM