



INSTALLATION • FASCIA & SOFFIT

Before you start



- Tape measure
- Square
- Bevel
- Clamps
- Hammer
- Pencil & marker pen
- Level
- Metal Snips
- Metal shears/nibbler
- Gloves & goggles
- Work bench

Installation Do's

- Use a pencil to mark cuts and avoid leaving pencil marks on visible surfaces
- Only cut using a hand-held metal shears or mechanical nibbler (Makita Cordless Shear DJS161 or similar recommended).
- Overlap joints and where possible use the factory cut edge on top.
- Use Infinity colour matched, stainless steel ring shanked nails only.
- Galvanised Steel is not suitable for marine or coastal environments where there is risk of salt air.
- Take care when handling longer lengths and adequately support 3m lengths during cutting and handling.
- Take care with sharp cut edges and use appropriate gloves to avoid cuts.
- Always use rubber headed hammers when working on the coated surfaces.
- Use Infinity touch-up paint on all cut edges.
- Care should be taken when working at height, observe your working environment and ensure that site safety equipment is used.

Installation Don'ts

- Do not leave pencil marks on visible surfaces.
- Do not under any circumstance use a mechanical grinder or hacksaw to cut Infinity, this will damage the galvanised core and result in potential rusting of cut edges which will invalidate the product warranty.
- Do not use steel or zinc plated fixing as this may result in rust run-off and decolouring of the coating.
- Do not use marker pen on visible surfaces as this will be difficult to remove.
- Do not use metal hammers on the products as this may result in damage to the coated surfaces and unnecessary scratching.

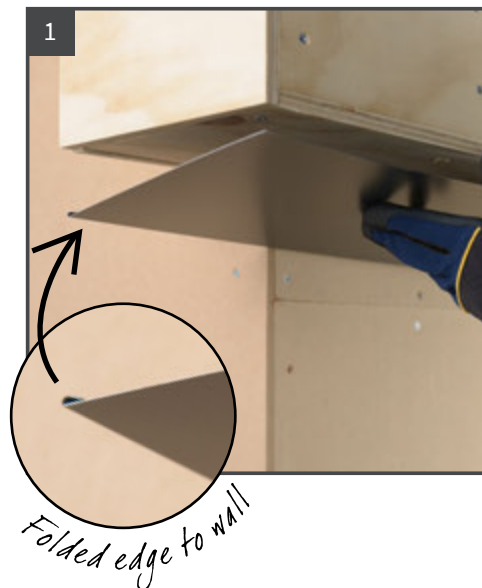

Soffit

The soffit must be installed first. The soffit is 3m long and has a folded return edge along one side, this is to give it rigidity at the wall edge.

Top Tip

Care should be taken when handling the soffit to avoid 'kinking' the folded edge.

INSTALLATION • FASCIA & SOFFIT

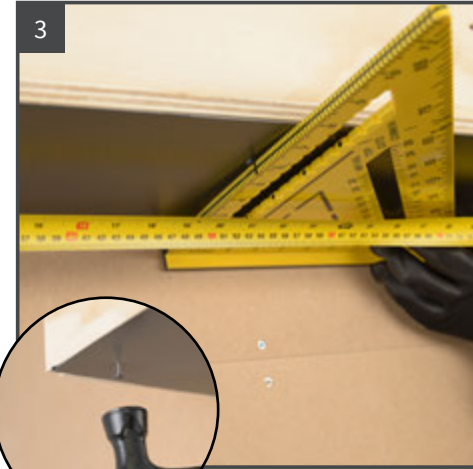

Cut edge hidden under fascia

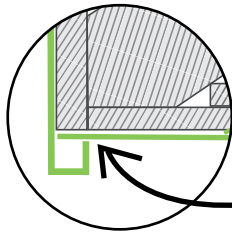

Cutting the Soffit to the correct width

The soffit can be easily cut to the right width using a metal nibbler or shears. The cut edge of the soffit will eventually sit in under the fascia edge so interface between the fascia and soffit usually allows for an element of tolerance in the cutting as illustrated.

Top Tip

Mark the soffit along its edge and lay it flat on a piece of wood at bench height to support the full length, clamp it at one end to make cutting easy.

Fix Soffit

Once cut to the correct width, fix the soffit with a minimum of 2 nails (approx. 30mm from both the width-wise edges) at 500mm intervals along the length using colour-matched, Infinity ring-shanked stainless steel nails as shown.

Top Tip

Pre-drill the nail spacing using 2mm drill bit to make nailing a breeze.

Overlap Soffit

Continue to install the soffit along the entire length of the building, overlapping each joint by a minimum of 25mm. For ease of installation, use Infinity adhesive tape at each joint to help hold the overlap in place while fixing.

Top Tip

Get someone to help hold up one end while you line-up and nail in the right position.

The future of roofline

INSTALLATION • FASCIA & SOFFIT

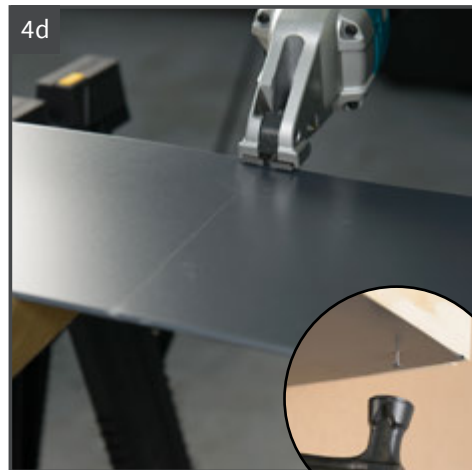
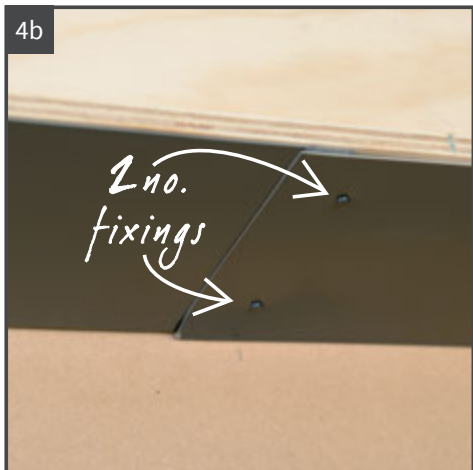
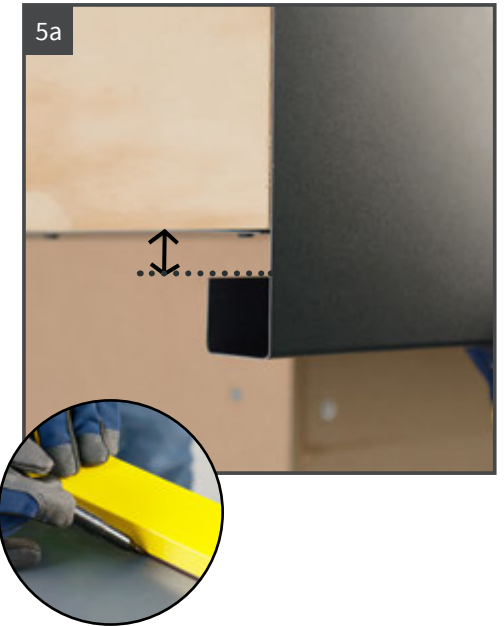

Fascia

Once the soffit is installed, proceed to fix the fascia. First offer the fascia up into place and ensure that the underside inside edge abuts to the soffit. If there is a gap, it is likely that the fascia will need trimming along its length to allow this gap to close. Variation in the substructure is to be expected so adjust each fascia section accordingly to accommodate any variance.

Top Tip

Measure twice, cut once!

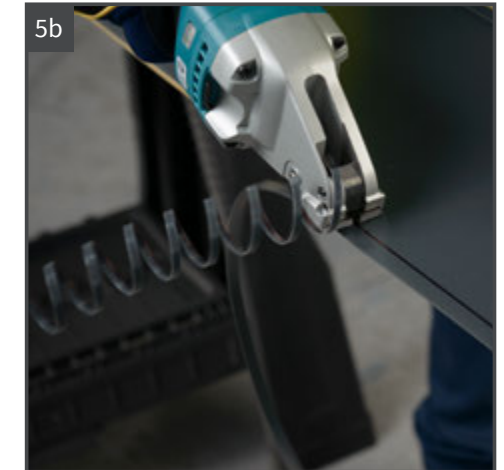

INSTALLATION • FASCIA & SOFFIT



Fix Fascia

Fix the fascia with a minimum of 2 nails at 750mm intervals along the length using Infinity ring-shanked stainless steel nails as shown.

Note: All joints must be fixed through using 25mm ring-shanked stainless steel nail as shown above.

Top Tip

Ensure fixings are positioned to fix securely into the wood substrate. It's recommended the fixings are a minimum of 25mm from the edge of the sub-fascia timber. Pre-drill the nail spacing using 2mm drill bit for ease of nailing.



Overlap Fascia

Continue to install the fascia along the entire length of the building, overlapping each joint by a minimum of 25mm. For ease of installation, use Infinity adhesive tape at each joint to help hold the overlap in place while fixing.

Top Tip

On the 'U' profile it is recommended that you cut away a section as shown above, to ensure the overlap will sit flush.

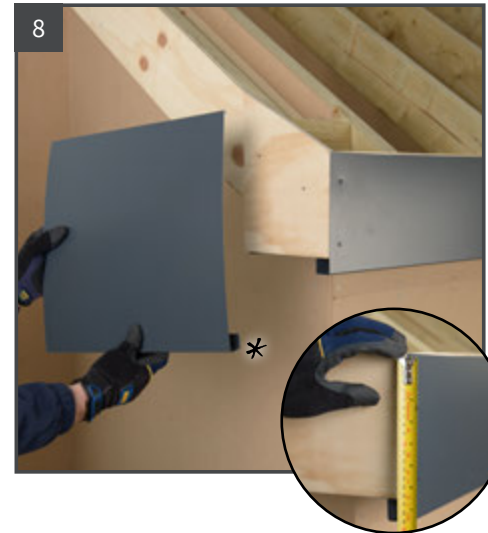

Gable Box End

For the gable box end, choose the correct sized gable box to suit your installation (choose from 400x400 or 600x600). Mark and cut the gable box end to size as shown.

Top Tip

Cut the Gable box in such a way that the Gable-End Barge Board overlaps it to give a weatherproof lap (see point 10 for reference).



The future of roofline

INSTALLATION • FASCIA & SOFFIT



Gable-End Barge Soffit

First fix the underside soffit board up the gable end (follow previous instruction points 1-4 overleaf).

Top Tip

Work from bottom to top, overlapping each joint to create a weatherproof join.

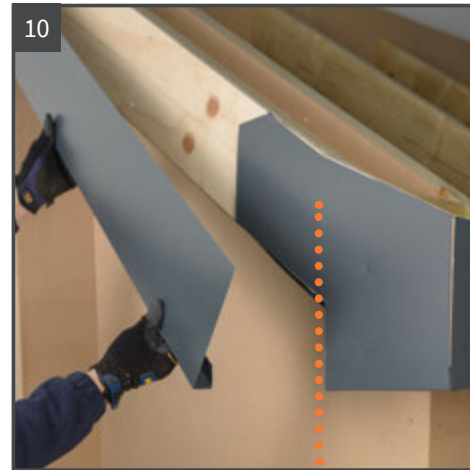

Once the soffit board is installed, proceed to fix the barge board following the same principle used to fix the fascia (points 5-7 overleaf) overlapping each joint by min. 25mm. Fix the barge over fascia using the larger 40mm nails.

At the intersection between the gable box and the barge board, simply overlap the barge fascia over the gable box as shown.

Top Tip

Some prefer to see a plum cut here so, if you prefer, simply mark and cut the profile using a metal nibbler or shears.

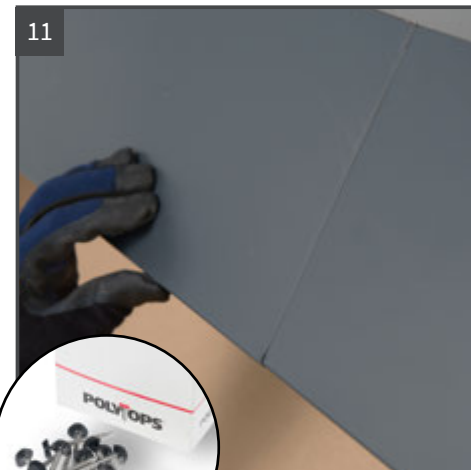

Fit the gable from bottom to top, this is important so that the overlap direction is weatherproof. Fix at 750mm centres using the larger fixing nail (3.2mm x 40mm).

Top Tip

Pre-drill the nail spacing using 3mm drill bit to make nailing a breeze. Position the fixings at equal positions and preferably at plumb-line for that professional touch!



At the ridge, it is recommended to cut the profile so as to overlap the joint. The best way to achieve this is to run one gable through, then overlap with the opposite side. Once in position, fix the joint using 3.2 x 40mm nails

Top Tip

Cut the overlapping piece with a plumb cut for that professional touch.

INSTALLATION • FASCIA & SOFFIT

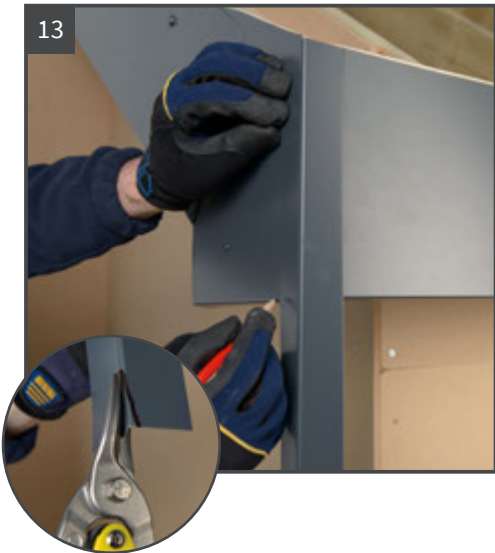

Measuring the Corner Trim

All corners can be finished using the universal corner trim. Offer the trim up to the corner as shown. Mark the length required, add 25mm to this length and cut to length. Using the original mark, cut a V shape in the corner.

Top Tip

Use a hand metal shears for accuracy and easy of use.



Fixing the Corner Trim

With the trim cut as shown in 13, offer the trim up to the gable corner to check its length.

At this stage it should protrude 25mm below the fascia.

Remove the self-adhesive tape and press firmly into place.

Top Tip

Use a small rubber mallet to create a crisp tight fold.

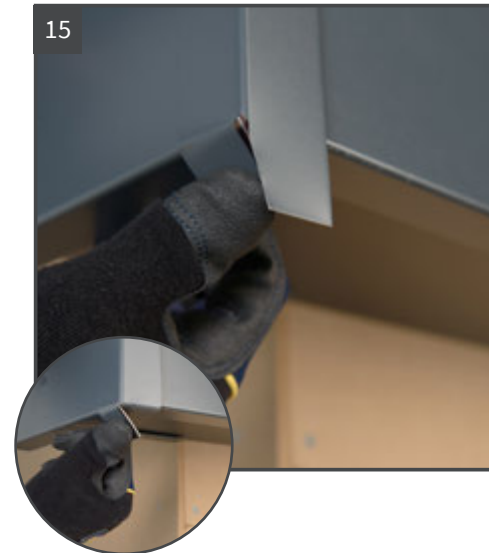

Bend the bottom of the trim to close off the bottom, overlapping as shown.

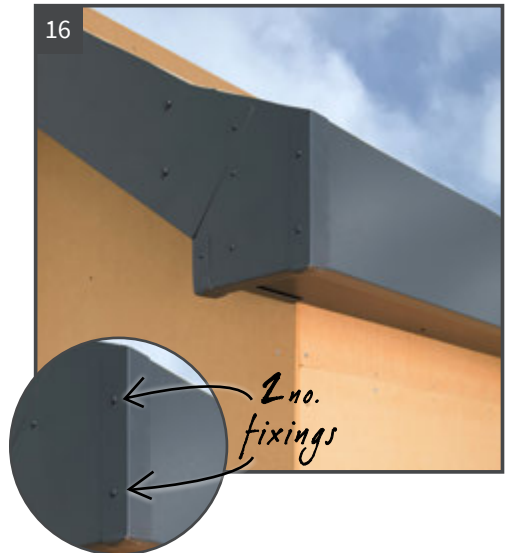

Once in position, fix using nails (minimum 2no recommended on the gable end).

